

ÅRSMØDET FOR DANSK SELSKAB FOR EUROPAFORSKNING  
SYDDANSK UNIVERSITET, ODENSE, 29-30 SEPTEMBER 2011

DSE ÅRSMØDET

ECSA-DK ANNUAL MEETING

*Convenor: University of Southern Denmark  
Organizers: Christilla Roederer-Rynning and Niels Lachmann*

The Danish Society for European Studies (DSE / ECSA-DK) and the Department of Political Science and Public Management at the University of Southern Denmark are pleased to invite to ECSA-DK's annual meeting, September 29<sup>th</sup> and 30<sup>th</sup> 2011 at the university's campus in Odense.

While the Lisbon Treaty has now become a reality, the EU still struggles to come out of the economic crisis and to develop reliable ways to build renewed confidence in the Euro. At the same time, events unfold in the Mediterranean region and the Middle East towards a process of democratization with transnational implications that raise a challenge to Europeans. In other words, global and regional developments require that European decision-makers provide collective solutions building on cultural, historical and political diversity.

True to tradition, we have invited an internationally renowned scholar to initiate our discussions of these events. This year, it is our great pleasure to have **Professor Berthold Rittberger**, Chair for International Politics at Ludwig-Maximilians-University Munich, as our keynote speaker. Professor Rittberger has done extensive work on processes of democratization within the EU, combining historical, sociological and political science perspectives in his research.

### **General information**

*CONFERENCE WEBSITE:* Information on the conference will be hosted by the homepage of the [Euro-politics research group](#), Department of Political Science, University of Southern Denmark.

*DEADLINE FOR SENDING PAPERS:* Papers must be sent to [dse2011@sam.sdu.dk](mailto:dse2011@sam.sdu.dk) no later than **September 20<sup>th</sup>**. Papers received at the deadline will be posted on the conference program page, but circulation by email among panelists is desirable. Panel chairs are responsible for circulating papers.

*CONFERENCE DINNER (own expenses):* All participants are invited to the conference dinner on September 29<sup>th</sup> ([www.oliviabrasserie.dk](http://www.oliviabrasserie.dk)). Please indicate your interest when registering online.

*ONLINE REGISTRATION:* To participate in the conference and conference dinner, register online at <http://webpay.sdu.dk/system/amdses11/> no later than **September 20<sup>th</sup>**. The fee is: 200 DKK for individual/institutional members of DSE; 350 DKK for non-members (includes a one-year individual membership). Lunch and coffee are included for conference participants. Payment by electronic transfer.

*ACCOMMODATION AND TRANSPORT:* A list of hotels and a description of how to get to the university from the train station in Odense are included in the program. Participants are advised to book their accommodation soon.

*ANNUAL MEETING OF THE DANISH SOCIETY FOR EUROPEAN STUDIES  
UNIVERSITY OF SOUTHERN DENMARK, ODENSE, 29-30 SEPTEMBER 2011*

**PROGRAM**

**SEPTEMBER 29<sup>TH</sup> 2011**

**PHD WORKSHOP OF ECSA-DK'S PHD NETWORK EU-STIP**

Guest and discussant: Professor Finn Laursen, Dalhousie University, Halifax  
Room O78

Besides participating in DSE's annual meeting, the PhD students of the EU-STIP network have the opportunity to discuss aspects of their research with Professor Finn Laursen in this workshop. Professor Laursen will also discuss concrete dilemmas he is confronted with in his research and how he addresses them.

Moderator: Christilla Roederer-Rynning, University of Southern Denmark

Participants: Jesper Dahl Kelstrup, Roskilde University

Juan Zhang, Aalborg University

Maria Ruxandra Lupu Dinesen, University of Copenhagen

Mette Buskjær Christensen, University of Southern Denmark

Sanne Brasch Kristensen, Roskilde University

Theodore Baird, Roskilde University

12:00 Lunch for participants at the SDU restaurant

13:30 1<sup>st</sup> workshop session

15:00 Coffee break

15:30 2<sup>nd</sup> workshop session

17:00 End of workshop

19:00 Conference dinner—all conference participants are invited (own expenses)

**SEPTEMBER 30<sup>TH</sup> 2011: ANNUAL MEETING**

- 9:00 Registration and coffee at the SDU main entrance, conference section
- 9:15 Welcome by DSE President and organizers  
Keynote speech by Prof. Berthold Rittberger, University of Mannheim:  
“Institutionalizing representative democracy in the EU: the case of the European Parliament” (Room O-100)
- 10:30 1<sup>st</sup> panel session (Rooms O94, O96, O97, O98, O100)
- 12:00 Lunch at university restaurant (only for registered participants)
- 13:00 2<sup>nd</sup> panel session (Rooms O94, O96, O97, O98, O100)
- 14:30 Coffee break at the SDU main entrance, conference section
- 15:00 Roundtable on EU and the media (Room O-100)  
3<sup>rd</sup> panel session
- 16:30 General assembly of DSE
- 18:00 End of meeting

## SECTIONS

### ***The EU as global actor (EUGA)***

Convenors: Annika Bergman Rosamond, Danish Institute for International Studies  
Ian Manners, Roskilde University  
Fabrizio Tassinari, Danish Institute for International Studies

### ***Democratization of the EU (DEMO)***

Convenors: Ann-Christina Lauring Knudsen, Aarhus University  
Christilla Roederer-Rynning, University of Southern Denmark

### ***Regulation and governance in the EU (REG)***

Convenor: Kennet Lynggaard, Roskilde University

### ***Reform policies and politics in the post-financial crisis context (REFP)***

Convenor: Caroline de la Porte, University of Southern Denmark

### ***The EU post-Lisbon (LISB)***

Convenor : Søren von Dosenrode, Aalborg University

### ***Methodological issues in the study of the EU (METH)***

Convenor: Derek Beach, Aarhus University

### ***Law, politics and public administration in the EU (LPPA)***

Convenors: Dorte Sindbjerg Martinsen, University of Copenhagen  
Ulla Neergaard, University of Copenhagen

The working language is English or Danish, depending on the panelists' preferences.

### ***Chart of panel sessions and their location***

	O100	O94	O96	O97	O98
10.30-12:00		REG	EUGA	REFP	DEMO
13:00-14:30	LISB	METH	EUGA		DEMO
15:00-16:30	Roundtable		EUGA	LPPA	

**FIRST PANEL SESSION**

**10:30 – 12:00**

***The EU as a global actor (EUGA): “EU intervention and ideology”***

Chair and discussant: Rebecca Adler-Nissen, University of Copenhagen

Room: O96

Ben Rosamond, University of Copenhagen

[European liberalisms and the rationalities of intervention](#)

Annika Bergman Rosamond, Danish Institute for International Studies

The European Union, moral agency and intervention

Ian Manners, Roskilde University

A ‘normative power’ approach to the EU’s efforts at conflict prevention and crisis management in the context of ‘sustainable peace’

Tony Bislimi, Dalhousie University, Halifax

The EU’s involvement in the Balkans

Annemarie Peen Rodt, University of Southern Denmark

[Evaluating EU performance in military conflict management](#)

***Democratization of the EU (DEMO): “The Parliamentarization of EU Politics”***

Chair: Ann-Christina Lauring Knudsen, Aarhus University

Discussant: Patrick Emmenegger, University of Southern Denmark

Room: O98

Ann-Christina Lauring Knudsen, Aarhus University

Transnational parliamentary careers: British and Danish Members of the European Parliament, January 1973 to June 1979

Morten J.W. Hansen, Aarhus University

[A transnational elite in the making?: Career patterns among Danish Members of the EP and the Council of Europe’s Parliamentary Assembly](#)

Mette Buskjær Christensen, University of Southern Denmark

[National Members of Parliament and their strategies towards the EU](#)

Christilla Roederer-Rynning, University of Southern Denmark & Frank Schimmelfennig, ETHZ

[Bringing codecision to agriculture: a hard case of parliamentarization](#)

***Reform policies and politics in the post-financial crisis context (REFP)***

Chair and discussant: Caroline de la Porte, University of Southern Denmark

Room: O97

Jon Kvist, University of Southern Denmark

Does the EU impact welfare reform?

Johan Bo Davidsson, University of Southern Denmark

One major and some minor reform types: an analytical overview of labor market reforms in Europe

Janine Leschke & Andrew Watt, European Trade Union Institute, Brussels

EU economic governance in the crisis and the conflict between austerity measures and the Europe 2020 goals

***Regulation and governance in the EU (REG)***

Chair and discussant: Kennet Lynggaard, Roskilde University

Room: O94

Karl Löfgren & Kennet Lynggaard, Roskilde University

The European Union: consumer, producer or co-producer of global regulatory authority?

Morten Kallestrup, Erhvervs- og Byggestyrelsen, ministry of Economy and Business Affairs

Differentiated integration?: the 'new approach' in Single Market regulation

Johannes Michelsen, University of Southern Denmark

[Europæisering: bliver medlemstaterne mere ens eller forskellige?](#)

Carsten Jakob Humlebæk & Henrik Høeg Müller, Copenhagen Business School

Søgen efter governance opad og nedad: centralisering af EU og decentralisering af Spanien som omvendt parallelle forløb

**SECOND PANEL SESSION**

**13:00 – 14:30**

*The EU as a global actor (EUGA): EU normative power and multilateralism*

Chair and discussant: Annika Bergman Rosamond, Danish Institute for International Studies

Room: O96

Sanne Brasch Kristensen, Roskilde University

[Normative power Europe and securitization in international societies: a reflection on the legitimacy of the EU's normative foundations in its relations with the SADC](#)

Niels Lachmann, University of Southern Denmark

[A distinct European way of cooperating?: the multilateral partnerships of the EU as an international crisis management actor](#)

Maria Ruxandra Lupu Dinesen, University of Copenhagen

[The EU and the revolutions in its neighborhood](#)

*Democratization of the EU (DEMO): Democracy in the EU between law and opinion*

Chair: Christilla Roederer-Rynning, University of Southern Denmark

Discussant: Pernille Boye Koch, University of Southern Denmark

Room: O98

Espen D. H. Olsen & Hans-Jörg Trenz, University of Copenhagen

Deliberative polling: a cure to the democratic deficit of the EU?

Erik Lonning & Kathrine Ravn Jørgensen, Copenhagen Business School

Folk og Forfatning: hinandens forudsætninger?

Irene Baron, Copenhagen Business School

Modstandsretten i europæiske demokratier

Jesper Dahl Kelstrup, Roskilde University

[Think tanks in the Danish knowledge regime](#)

***Methodological issues in the study of the EU (METH)***

Chair and discussant: Derek Beach, Aarhus University

Room: O94

Ben Rosamond, University of Copenhagen

Methodology in EU studies

Kennet Lynggaard, Roskilde University

Research strategies in EU studies

Ann-Christina Lauring Knudsen, Aarhus University

History and the study of the EU

Julie Hassing Nielsen, European University Institute

Deliberation? Really?: an experiment as to what degree deliberation generates trust

***Europe after Lisbon (LISB)***

Chair: Søren von Dosenrode, Aalborg University

Discussant: Sten Rynning, University of Southern Denmark

Room: O-100

Finn Laursen, Dalhousie University, Halifax

[The European External Action Service](#)

Søren von Dosenrode, Aalborg University

Assessing the European Union's statehood

Svend Erik Hougaard Jensen, Copenhagen Business School

A stable and enforceable framework for fiscal policy in the Euro area



**THIRD PANEL SESSION**

**15:00 – 16:30**

*The EU as a global actor (EUGA): “Practices of EU external relations”*

Chair and discussant: Ian Manners, Roskilde University

Room: O96

Rebecca Adler-Nissen, University of Copenhagen

The European External Action Service

Sevasti Chatzopoulou, Roskilde University

The external dimensions of the EU agencification in the food chain and chemicals

Michael Herslund, Copenhagen Business School

[EU's udvidelser i geopolitisk perspektiv](#)

Wolfgang Zank, Aalborg University

[A region of crises: North Africa under the influence of Arab, African and European integration processes](#)

*Law, politics and public administration in the EU: institutional roles and relations in EU governance and compliance (LPPA)*

Chairs: Dorte Sindbjerg Martinsen and Ulla Neergaard, University of Copenhagen

Discussant: Morten Kallestrup, Erhvervs- og Byggestyrelsen, Ministry of Economy and Business Affairs

Room: O97

Michael Gøtze, University of Copenhagen

Folketingets ombudsmands manglende brug af EU-ret

Mogens Hobolth, London School of Economics & Dorte Sindbjerg Martinsen, University of Copenhagen

Informal dispute settlement and the domestic application of EU law

Marlene Wind, University of Copenhagen

Overlapping justice? Third country nationals and the implementation of the Citizenship directive in Denmark, Finland and the United Kingdom

Jens Blom Hansen, Aarhus University

[The post-Lisbon battle over comitology: another round of the politics of structural choice?](#)

**ROUNDTABLE**

**The EU in Denmark: The 2012 Danish Presidency and the Media**  
15:00-16:30, Room O-100

Moderator:

Arjen van Dalen, University of Southern Denmark

Speakers:

Chiara Valentini, University of Aarhus

Claes H. de Vreese, University of Amsterdam/University of Southern Denmark

Lars Peter Levy, Chief advisor, head of EU2012 communication team, ministry of foreign affairs

Søren Riishøj, University of Southern Denmark

## PRACTICAL INFORMATION

### Access to the university

The University of Southern Denmark's campus in Odense is located to the South-East of the city center. Taxis can be found at the North side exit (Dannebrogsgade) of the train station. From the train station, Fynbus line 40/41 runs approximately every ten minutes to the university (around 20 DKr. and max. 30 minutes for the trip). For the university's main entrance, you need to leave at the first stop on the campus (Svømmehallen). Other bus lines stopping within walking distance (15 minutes) of the university are lines 71, 81 and 82. For more information, visit [www.fynbus.dk](http://www.fynbus.dk). Access maps to the campus are available at <http://sdu.dk/servicenavigation/left/Vejviser/Odense>.

### List of accommodations

#### *Train station/city center (see map)*

CabInn Hotel Odense, Østre Stationsvej 7, <http://www.cabinn.com/hotel-i-odense/hotel-cabinn-odense.html>  
City Hotel Odense, Hans Mules Gade 5, <http://www.cityhotelodense.eu/>  
Hotel Ansgar, Østre Stationsvej 32, <http://www.millinghotels.dk/ansgar/>  
Hotel Domir, Hans Tausensgade 19, <http://www.domir.dk/>  
Hotel Plaza, Østre Stationsvej 24, <http://www.millinghotels.dk/plaza/>  
Hotel Windsor, Vindegade 45, <http://www.millinghotels.dk/windsor/>  
Radisson Blu H.C. Andersen Hotel, Claus Bergs Gade 7, <http://www.radissonblu.com/hotel-odense>  
Ydes Hotel, Hans Tausensgade 11, <http://www.ydes.dk/>

#### *Between city and university*

Best Western Hotel Knudsens Gård, Hunderupgade 2, <http://www.knudsensgaard.dk/>  
Odense Congress Center, Ørbækvej 350, <http://www.occ.dk/>

#### *Bed&breakfast/hostel*

Alberte Bed&Breakfast, Sophie Breums Vej 10, <http://www.albertte.dk/>  
Amalie Bed&Breakfast, Juelsgade 32, <http://www.amallie.dk/>  
Bed&Breakfast Odense, Helgavej 10, <http://www.bedbreakfastodense.dk/>  
Danhostel Odense City, Østre Stationsvej 31, <http://www.cityhostel.dk/>  
Engvejen Bed&Breakfast, Engvej 9, <http://www.bbengvej9.dk/>  
Odense sleep-well, Christian IXs Vej 23, <http://www.odense-sleep-well.dk/>  
Odinstårnet, Odinsgade 44, <http://www.odinstaarnet.eu/>  
Skibhus Bed&Breakfast, Skibhusvej 152, <http://www.skibhus-bb.dk/>

ÅRSMØDET FOR DANSK SELSKAB FOR EUROPAFORSKNING  
SYDDANSK UNIVERSITET, ODENSE, 29-30 SEPTEMBER 2011

Meeting area

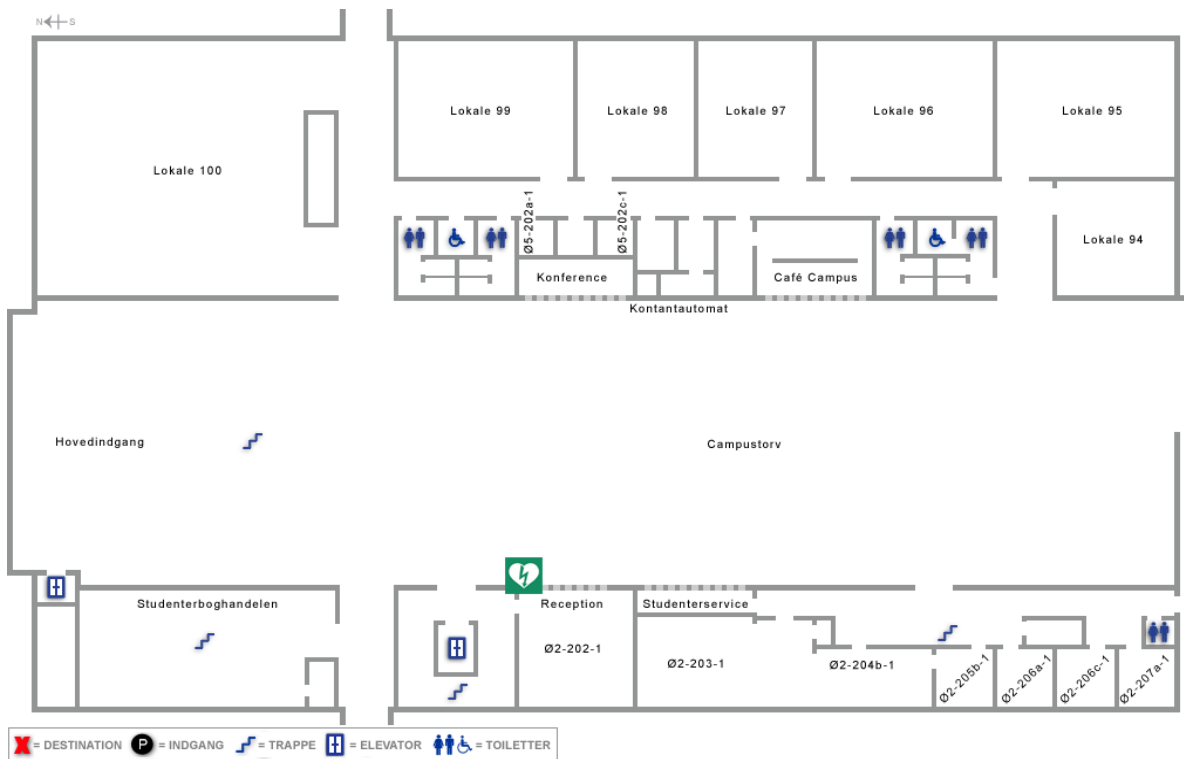

Access to room O-78 (in continuation of the entrance area)

<http://vejviser.sdu.dk/opslag?lid=1581>

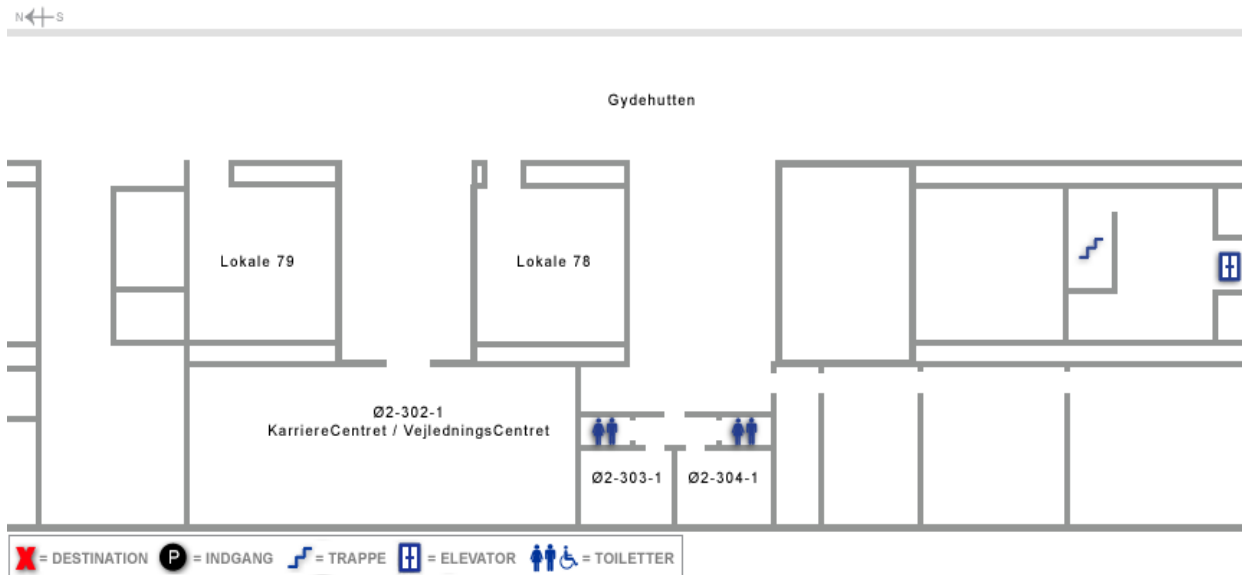

**List of participants**

Ann-Christina Lauring Knudsen, Aarhus University, [alknudsen@hum.au.dk](mailto:alknudsen@hum.au.dk)  
Annemarie Peen Rodt, University of Southern Denmark, [apr@sam.sdu.dk](mailto:apr@sam.sdu.dk)  
Annika Bergman Rosamond, Danish Institute for International Studies, [abr@diis.dk](mailto:abr@diis.dk)  
Arjen van Dalen, University of Southern Denmark, [avd@sam.sdu.dk](mailto:avd@sam.sdu.dk)  
Ben Rosamond, University of Copenhagen, [br@ifs.ku.dk](mailto:br@ifs.ku.dk)  
Berthold Rittberger, Ludwigs-Maximilians-University Munich, [Berthold.Rittberger@uni-mannheim.de](mailto:Berthold.Rittberger@uni-mannheim.de)  
Caroline de la Porte, University of Southern Denmark, [cpo@sam.sdu.dk](mailto:cpo@sam.sdu.dk)  
Carsten Jakob Humlebæk, Copenhagen Business School, [ch.ikk@cbs.dk](mailto:ch.ikk@cbs.dk)  
Chiara Valentini, Aarhus University, [chv@asb.dk](mailto:chv@asb.dk)  
Christilla Roederer-Rynning, University of Southern Denmark, [crr@sam.sdu.dk](mailto:crr@sam.sdu.dk)  
Claes H. de Vreese, University of Amsterdam/U. of Southern Denmark, [c.h.devreese@uva.nl](mailto:c.h.devreese@uva.nl)  
Derek Beach, Aarhus University, [derek@ps.au.dk](mailto:derek@ps.au.dk)  
Dorte Sindbjerg Martinsen, University of Copenhagen, [DM@ifs.ku.dk](mailto:DM@ifs.ku.dk)  
Erik Lonning, Copenhagen Business School, [el.first@cbs.dk](mailto:el.first@cbs.dk)  
Finn Laursen, Dalhousie University, [Finn.Laursen@dal.ca](mailto:Finn.Laursen@dal.ca)  
Hans-Jörg Trenz, University of Copenhagen, [trenz@hum.ku.dk](mailto:trenz@hum.ku.dk)  
Henrik Høeg Müller, Copenhagen Business School, [hhm.isv@cbs.dk](mailto:hhm.isv@cbs.dk)  
Ian Manners, Roskilde University, [manners@ruc.dk](mailto:manners@ruc.dk)  
Irene Baron, Copenhagen Business School, [irb.ikk@cbs.dk](mailto:irb.ikk@cbs.dk)  
Janine Leschke, European Trade Union Institute, [jleschke@etui.org](mailto:jleschke@etui.org)  
Jens Blom-Hansen, Aarhus University, [jbh@ps.au.dk](mailto:jbh@ps.au.dk)  
Jesper Dahl Kelstrup, Roskilde University, [kelstrup@ruc.dk](mailto:kelstrup@ruc.dk)  
Juan Zhang, Aalborg University, [jiuan@ihis.aau.dk](mailto:jiuan@ihis.aau.dk)  
Johan Bo Davidsson, University of Southern Denmark; [jbd@sam.sdu.dk](mailto:jbd@sam.sdu.dk)  
Johannes Michelsen, University of Southern Denmark, [jm@sam.sdu.dk](mailto:jm@sam.sdu.dk)  
Jon Kvist, University of Southern Denmark, [kvi@sam.sdu.dk](mailto:kvi@sam.sdu.dk)  
Julie Hassing Nielsen, European University Institute, [Julie.Nielsen@eui.eu](mailto:Julie.Nielsen@eui.eu)  
Julie Herschend Christoffersen, Danish Institute for International Studies, [jhc@diis.dk](mailto:jhc@diis.dk)  
Kathrine Ravn Jørgensen, Copenhagen Business School, [krj.ikk@cbs.dk](mailto:krj.ikk@cbs.dk)  
Kennet Lynggaard, Roskilde University, [kennetl@ruc.dk](mailto:kennetl@ruc.dk)  
Lars Peter Levy, Ministry of Foreign Affairs  
Maria Ruxandra Lupu Dinesen, University of Copenhagen, [mrlld@ifs.ku.dk](mailto:mrlld@ifs.ku.dk)  
Marlene Wind, University of Copenhagen, [mwi@ifs.ku.dk](mailto:mwi@ifs.ku.dk)  
Mette Buskjær Christensen, University of Southern Denmark, [mbch@sam.sdu.dk](mailto:mbch@sam.sdu.dk)  
Michael Götze, University of Copenhagen, [Michael.Gotze@jur.ku.dk](mailto:Michael.Gotze@jur.ku.dk)  
Michael Herslund, Copenhagen Business School, [mh.ikk@cbs.dk](mailto:mh.ikk@cbs.dk)  
Mogens Hobolth, London School of Economics, [m.h.hobolth@lse.ac.uk](mailto:m.h.hobolth@lse.ac.uk)

*ÅRSMØDET FOR DANSK SELSKAB FOR EUROPAFORSKNING  
SYDDANSK UNIVERSITET, ODENSE, 29-30 SEPTEMBER 2011*

Morten J.W. Hansen, Aarhus University, [ihomjwh@hum.au.dk](mailto:ihomjwh@hum.au.dk)  
Morten Kallestrup, Erhvervs- og Byggestyrelsen, [MKL@ebst.dk](mailto:MKL@ebst.dk)  
Niels Lachmann, University of Southern Denmark, [lach@sam.sdu.dk](mailto:lach@sam.sdu.dk)  
Patrick Emmenegger, University of Southern Denmark, [emm@sam.sdu.dk](mailto:emm@sam.sdu.dk)  
Pernille Boye Koch, University of Southern Denmark, [pbk@sam.sdu.dk](mailto:pbk@sam.sdu.dk)  
Rebecca Adler-Nissen, University of Copenhagen, [ran@ifs.ku.dk](mailto:ran@ifs.ku.dk)  
Sanne Brasch Kristensen, Roskilde University, [sanneb@ruc.dk](mailto:sanneb@ruc.dk)  
Sevasti Chatzopoulou, Roskilde University, [seva@ruc.dk](mailto:seva@ruc.dk)  
Sten Rynning, University of Southern Denmark, [sry@sam.sdu.dk](mailto:sry@sam.sdu.dk)  
Svend Erik Hougaard Jensen, Copenhagen Business School, [shj.eco@cbs.dk](mailto:shj.eco@cbs.dk)  
Søren Riishøj, University of Southern Denmark, [sr@sam.sdu.dk](mailto:sr@sam.sdu.dk)  
Søren von Dosenrode, Aalborg University, [sd@ihis.aau.dk](mailto:sd@ihis.aau.dk)  
Theodore Baird, Roskilde University, [baird@ruc.dk](mailto:baird@ruc.dk)  
Tony Bislimi, Dalhousie University, [bislimi@dal.ca](mailto:bislimi@dal.ca)  
Ulla Neergaard, University of Copenhagen, [Ulla.Neergard@jur.ku.dk](mailto:Ulla.Neergard@jur.ku.dk)  
Wolfgang Zank, Aalborg University, [wzank@ihis.aau.dk](mailto:wzank@ihis.aau.dk)

**Committee of the Danish Society for European Studies**

Derek Beach, Aarhus University, [derek@ps.au.dk](mailto:derek@ps.au.dk), president  
Ann-Christina Lauring Knudsen, Aarhus University, [alknudsen@hum.au.dk](mailto:alknudsen@hum.au.dk)  
Annika Bergman-Rosamond, Danish Institute for International Studies, [abr@diis.dk](mailto:abr@diis.dk)  
Christilla Roederer-Rynning, University of Southern Denmark, [crr@sam.sdu.dk](mailto:crr@sam.sdu.dk)  
Dorte Sindbjerg Martinsen, University of Copenhagen, [DM@ifs.ku.dk](mailto:DM@ifs.ku.dk)  
Henrik Plaschke, Aalborg University, [plaschke@epa.aau.dk](mailto:plaschke@epa.aau.dk)  
Ian Manners, Roskilde University, [manners@ruc.dk](mailto:manners@ruc.dk)  
Kennet Lynggaard, Roskilde University, [kennetl@ruc.dk](mailto:kennetl@ruc.dk)  
Peter Nedergaard, University of Copenhagen, [pne@ifs.ku.dk](mailto:pne@ifs.ku.dk)  
Rebecca Adler Nielsen, University of Copenhagen, [ran@ifs.ku.dk](mailto:ran@ifs.ku.dk)  
Susana Borrás, Copenhagen Business School, [sb.dbp@cbs.dk](mailto:sb.dbp@cbs.dk)  
Svend Erik Hougaard Jensen, Copenhagen Business School, [shj.eco@cbs.dk](mailto:shj.eco@cbs.dk)  
Søren von Dosenrode, Aalborg University, [sd@ihis.aau.dk](mailto:sd@ihis.aau.dk)  
Ulla Neergaard, University of Copenhagen, [Ulla.Neergard@jur.ku.dk](mailto:Ulla.Neergard@jur.ku.dk)